

Setting Up a Grid 3 User Profile

Introduction

Setting up a user profile in Grid 3 involves creating a personalized environment tailored to the user's specific needs and abilities. Here's a step-by-step guide on how to set up a Grid 3 user profile.

Learning Objectives

Completing this tutorial will give you experience:

- Setting up a new user profile in Grid 3.
- Navigating the settings section in Grid 3.

This tutorial assumes that

- You are using a Windows based device.
- You are new to using Grid 3.
- You have the free trial of Grid 3 installed.

Steps to Follow

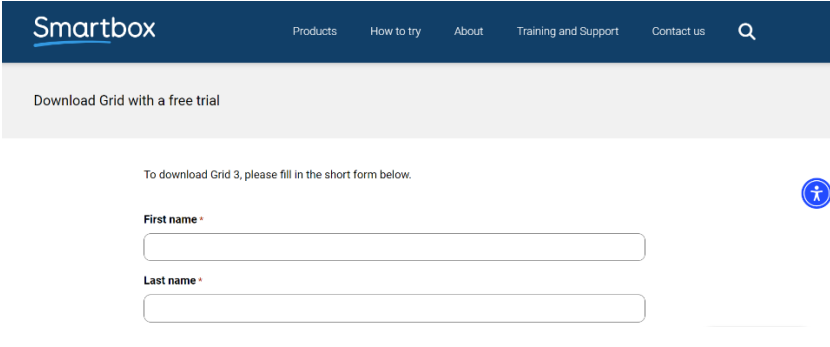
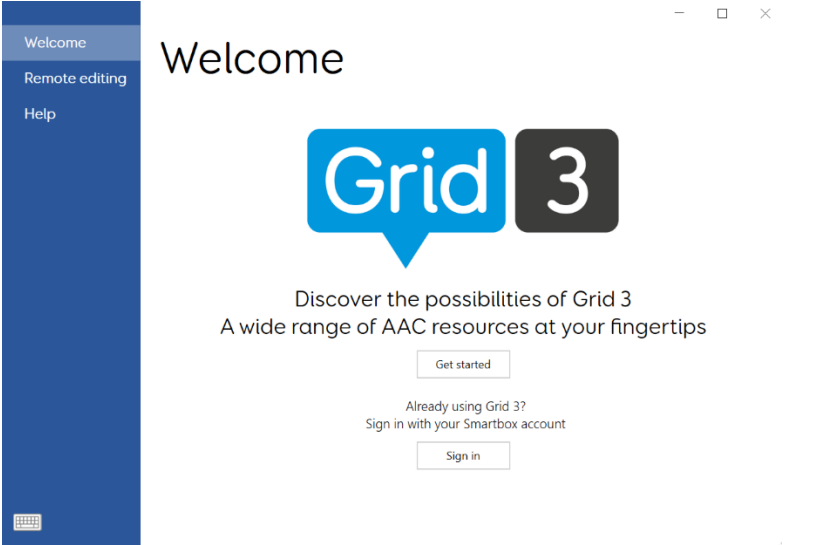
Step	Instruction	Visual Depiction
1	<p>Install and Open Grid 3:</p> <ul style="list-style-type: none"> - Ensure that Grid 3 is installed on your device. - Open the Grid 3 application. 	 <p>The screenshot shows the Smartbox website header with navigation links: Products, How to try, About, Training and Support, and Contact us. Below the header is a grey banner that says "Download Grid with a free trial". Underneath, there is a text prompt: "To download Grid 3, please fill in the short form below." followed by two input fields labeled "First name" and "Last name". A small blue circular icon with a white 'f' is visible in the bottom right corner of the form area.</p>
2	<p>Create a New User Profile - click on “Get Started” and enter the User’s details.</p> <p>Alternatively access User Settings: On the main screen of Grid 3, look for the "Users" section.</p> <ul style="list-style-type: none"> - Add New User by clicking on " New". This will prompt you to enter details for the new user. - Enter User Details: Provide the user’s name and other relevant details. This will help you manage multiple profiles if needed. 	 <p>The screenshot shows the Grid 3 application interface. On the left is a dark blue sidebar with a white keyboard icon at the bottom, containing the menu items: Welcome, Remote editing, and Help. The main content area has a white background with the word "Welcome" in a large font. Below that is the "Grid 3" logo, where "Grid" is in a blue speech bubble and "3" is in a dark grey square. Underneath the logo, the text reads: "Discover the possibilities of Grid 3" and "A wide range of AAC resources at your fingertips". At the bottom of the main area, there are three buttons: "Get started", "Sign in", and "Sign in with your Smartbox account".</p>

Step Instruction Visual Depiction

3 Choose a Grid Set
 - Select a Pre-made Grid Set: Grid 3 comes with several pre-made grid sets tailored to different types of users, such as communication, environmental control, or education. Browse through these options and select the one that best fits the user's needs.

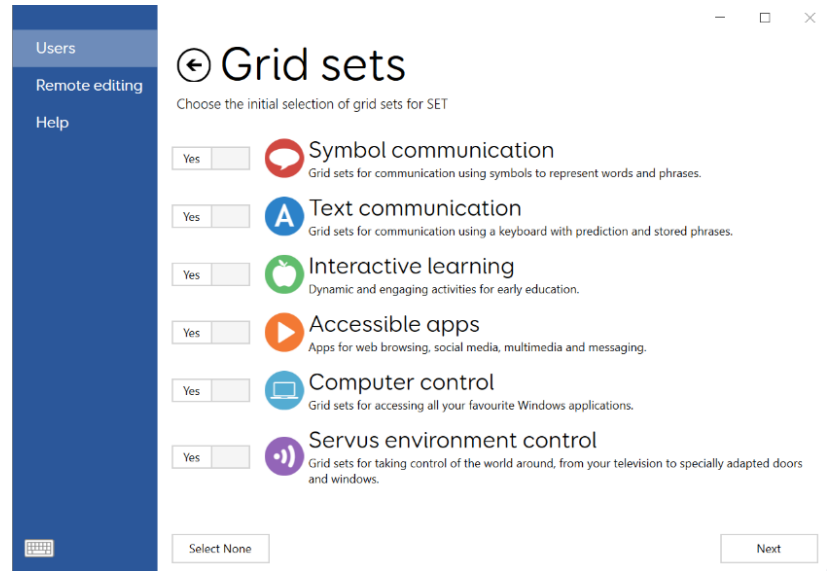

- Create a Custom Grid Set: If you prefer to build a grid from scratch, you can select the "Select None" option and then click "Next". From the menu of the next screen click on "Add grid set" > "Create a blank grid set".

Step Instruction Visual Depiction

4 Customize the Grid Set
 - click on “Edit Grids”
 from the menu at the top left: Once you’ve selected or created a grid set, you can customize it by adding or removing cells (buttons), changing icons, labels, and setting actions for each cell (e.g., speak a word, open an app, control a device).

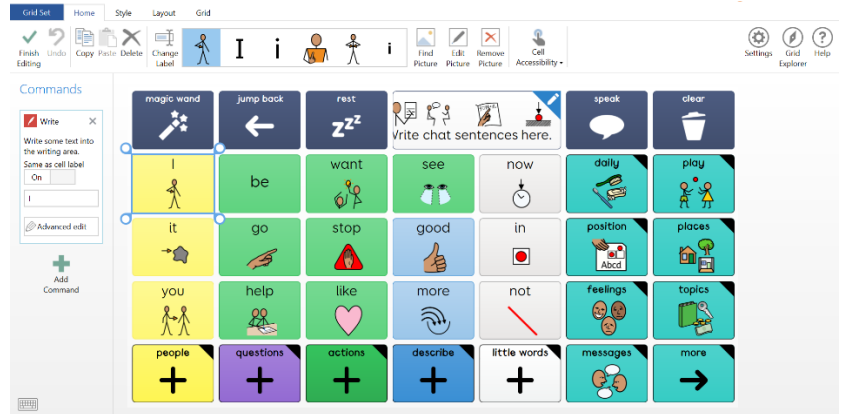

See the tutorial on editing Grid Sets.

5 Test the Profile
 - Test the Grids: Go through the grid set with the user to ensure it meets their needs and is easy to use.
 - Make Adjustments: Based on feedback, make any necessary adjustments to the grids, input methods, or settings.

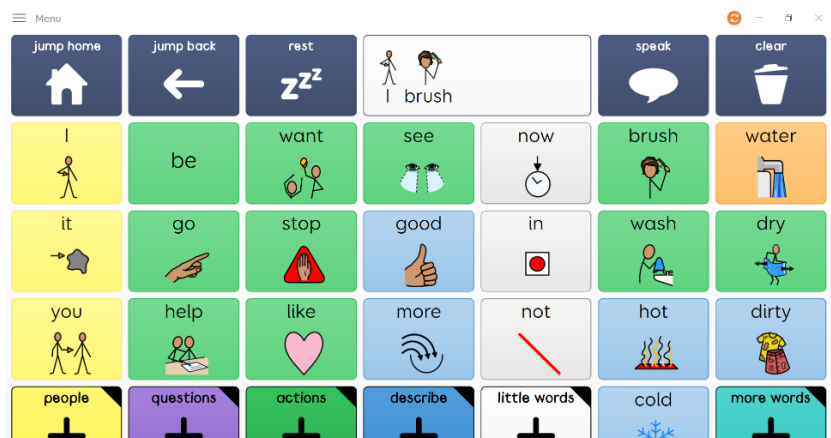

Step	Instruction	Visual Depiction
------	-------------	------------------

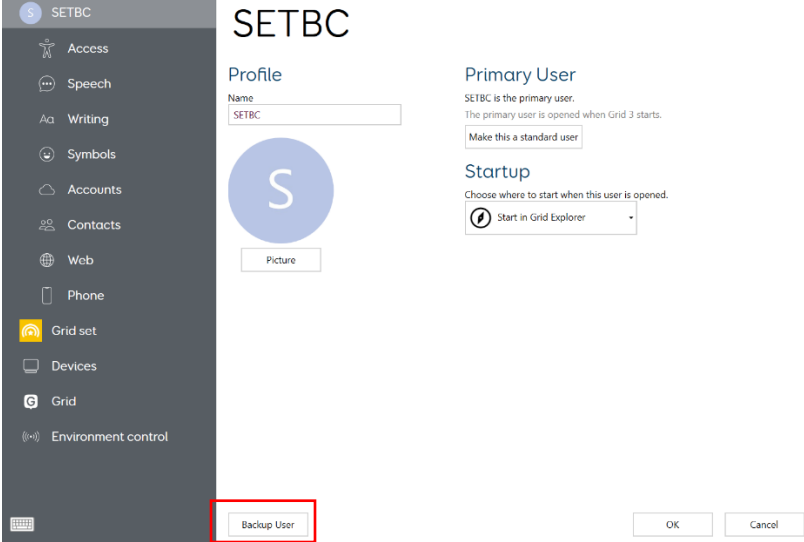
6	<p>Save and Back Up</p> <p>- Create a Backup: It's a good idea to create a backup of the user profile in case you need to restore it later. This can be done in the "Settings" and select "Backup User".</p>	
---	--	--

