

Big Bang Patterns with 1 Switch Control.

Introduction

This tutorial explains how to set up Big Bang Patterns with 1 switch control using the Pretorian APPLICATOR Bluetooth switch interface.

Big Bang Patterns is an app that has been designed to work with 1 or 2 switches in addition to touch screen control. This tutorial requires:

- 1 wired switch
- Pretorian APPLICATOR switch interface
- iPad iOS version 15.6.1 or higher
- Big Bang Patterns app – Inclusive Technology Ltd.

Charging the APPLICATOR

- 1 Charge the APPLICATOR using the cable provided.
 Plug the cable into a USB Port.
 The charging light will be green.
 The light will disappear once the device is fully charged.



Configure the APPLICATOR

- 2 **Wake up** the APPLICATOR by pressing any button.
 A swirling pattern will appear in the display area.

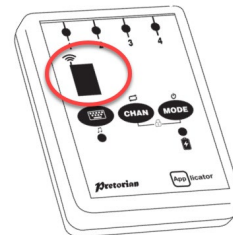

Pair the APPLICator to the iPad.

Open the **Settings** menu.

Slide **Bluetooth** to **On**.

3 The APPLICator will appear as a discoverable device.

Select the **APPLICator** to complete pairing.

The swirling light in the display area will disappear. Confirm that the device is **Connected**.

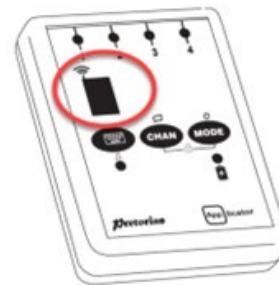
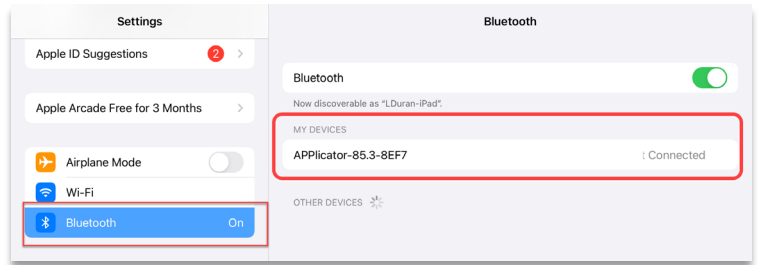

Adjust iPad Keyboard settings.

Open the iPad **Settings** menu.

4 Tap **General**

Locate **Keyboard**

Toggle **Shortcuts and Predictive** OFF.

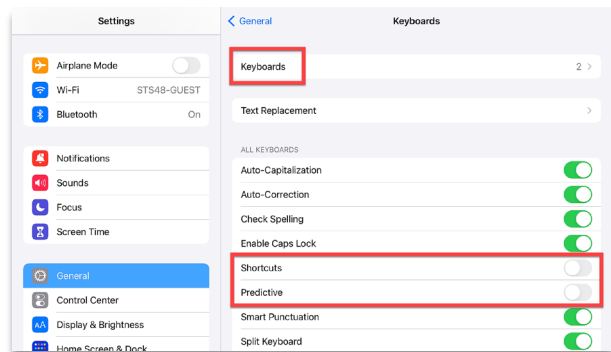

Program APPLICator channel 1 to Mode 6:

5 Connect a wired switch to **Channel 1**.

Press the **Channel** button to move the light to **Channel 1**.

Press the **Mode** button on the APPLICator to **6** (Enter).



Set up Big Bang Patterns 1 Switch Access

Launch Big Bang Patterns

6

Tap **Settings**.

Choose **Switch Access**.

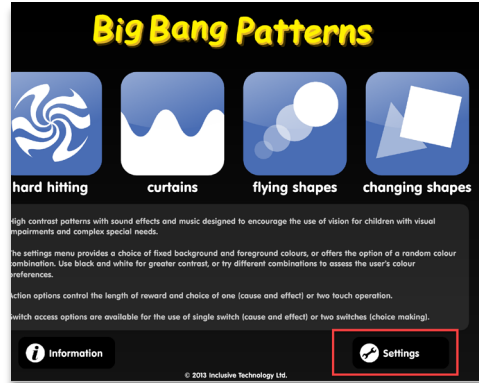

7

Tap **Enable Switch**.

Choose **1 Switch**.

Close this menu.

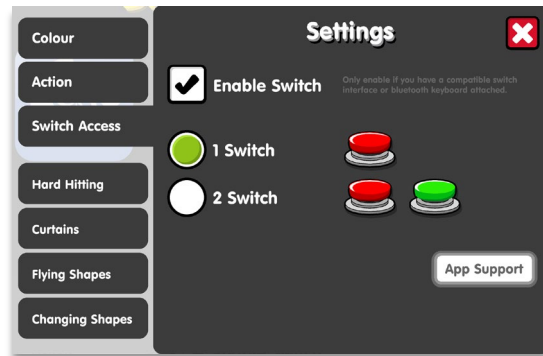

8

Launch a preferred pattern.

The switch should turn the pattern ON.

Wait for the pattern to finish before turning the next pattern ON using the switch.

